

Low voltage and high frequency ionizing air blower KF-06W (constant air volume)



Technical Parameters

Category	Parameters	Category	Parameters
Model	KF-06W	Air volume	0.55-0.71m ³ /min (constant air volume)
Input voltage	DC24V	Ozone concentration	0.03ppm(distance 150mm)
Decay time	1.5s(200mm)	Working temperature	0-40°C
Ion balance	Automatic ion balance system 0±15V	Working humidity	30-70%RH(No condensation or water droplets)

Test conditions working voltage:DC24V testing voltage: ±1000V-±100V Temperature: 23°C±2°C

Distance	Decay time (+/-)	Ion balance (+/-)
200mm	1.5s/-2.0s	0±15V
300mm	2.0s/-2.5s	0±15V

Remark: 1. Testing method: Using charged plate monitor to test.
2. Decay time means with the maximum air volume from ±1000V to ±100V.
3. Test in the central area of the front air window.

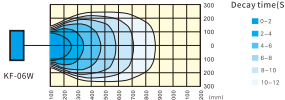

Features

- 01 Apply high frequency AC type to achieve excellent ion balance.
- 02 Special tungsten alloy discharge needle for longer service time.
- 03 Unique appearance design and visual management of working performance.
- 04 Removable discharge needle parts and the front window, convenient for cleaning, maintenance and replacement.

Ionizing air blower KF-06W (constant air volume)

Dimension /84.5×55×112mm Weight /0.56kg (including stand)

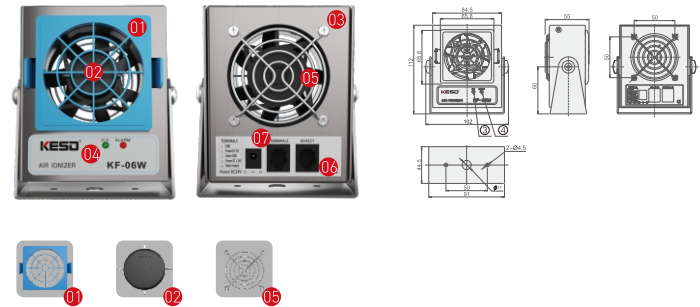

- 01 **Front window (KF-06W-BL)**
The linear grid type air window is used to make the blow wind linear, increase the static elimination effect, and can be flexibly disassembled for easy maintenance.
Accessory, can be purchased separately.
- 02 **Discharge needle (KF-06W-Z1)**
Discharge needle parts can be disassembled for replacement and maintenance. Cleaning or maintenance outside the working area to avoid secondary pollution.
Accessory, can be purchased separately.
- 03 **Housing**
The outer casing is made of stainless steel, which is more suitable for use in clean rooms.
- 04 **Indicator**
 - Green lights on in normal working condition.
 - H.V
 - Red lights on in abnormal operating condition.
- 05 **Metal window mesh (60x60mm)**
Accessory, can be purchased separately.
- 06 **Network socket**
- 07 **Power socket**